

JVC®

The Perfect Experience / —

FIXED COLOUR DOME CAMERA

TK-C205E(A)

(AC 24 V/DC 12 V)

Easy Plug & Play Dome Camera with 540 TVL and Easy Day/Night Function

◆ **1.6 Super LoLux™**
lx (B&W Mode)

◆ **0.7 Super LoLux™**
lx (B&W Mode)

◆ **2.4 Super LoLux™**
lx (Colour Mode)

◆ **0.9 Super LoLux™**
lx (Colour Mode)

with clear dome cover



540 TV Lines Easy Day/Night



- 1/4" High resolution IT CCD with 440,000 effective pixels
- 540 TV lines horizontal resolution
- Easy day/night function: Chroma on/off
- Super LoLux sensitivity: 2.4 lx F1.2 (Colour mode), 1.6 lx F1.2 (B&W mode)
- Signal-to-Noise ratio: 50 dB
- Revolutionary integrated 10-bit DSP
- Built-in variable focal length auto iris lens (f = 2.6 mm to 6.0 mm)
- Full featured security camera
 - Monitor video output (RCA) for easy camera setup
 - Automatic gain control (AGC) on/off
 - Auto tracking white balance (ATW) and manual modes: 2,300K to 10,000K
 - Easy focus adjustment
 - Backlight compensation on/off
 - Sync systems INT/Line lock
 - AC 24 V/DC 12 V power supply

High-performance plug & play dome camera with 540 TVL resolution, enhanced LoLux sensitivity, and convenient day/night function.

Packed with JVC's latest technology, this all-in-one camera solution not only delivers outstanding image performance with 540 TVL horizontal resolution, it also boasts a new easy-to-install mechanism for plug & play setup, to reduce total price including installation costs. As a full-spec camera, the TK-C205E(A) comes with all the high-performance features you expect, including Super LoLux sensitivity, colour matrix, high signal-to-noise ratio, and flexible power supply (AC 24 V/DC 12 V). And, thanks to the Easy day/night function, which automatically switches to B&W mode in low-light situations, you are assured optimum imaging performance 24 hours a day.

Easy day/night function

TK-C205E(A) automatically uses colour mode when the subject is bright, and B&W mode when it is very dark. In B&W mode, AGC is always active to achieve high performance even in low light situations.

Built-in revolutionary DSP

JVC's innovative DSP automatically adjusts camera parameters to ensure that sharp and natural pictures of 540 TV lines horizontal resolution combine with high quality performance.

1/4" High resolution IT CCD with 440,000 effective pixels

TK-C205E(A) comes with a 1/4" interline transfer CCD for accurate colour reproduction and signal-to-noise ratio of 50 dB (AGC off).

Detail corrections — horizontal and vertical (2H)

TK-C205E(A) provides dual-edged detail correction — horizontal and vertical with 2H line memory.

Automatic gain control (AGC)

With Super LoLux sensitivity, as ambient light level falls, Automatic gain control (AGC) increases the camera's sensitivity to 2.4 lx (Colour mode).

Manual or Automatic (ATW) white balance

For flexibility of operation in a wide range of environments the white balance can be set manually or can be automatically adjusted in real time by the Automatic tracking white balance (ATW) function over a range of 2,300K to 10,000K.

Easy focus adjustment

When the focus adjustment switch [FOCUS ADJ. - ON/OFF] is set to ON, focus adjustment is possible in extreme environments with the iris opened. Enhanced focusing accuracy enables optimum focus to be obtained even in the dark.

Controls, connectors and indicators

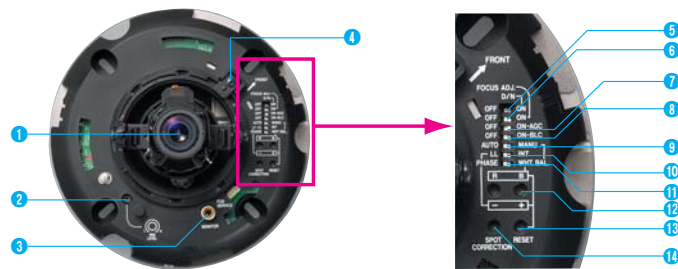

- 1 Camera head/lens
- 2 [IRIS LEVEL] Iris level adjustment knob
- 3 MONITOR terminal (RCA pin)
- 4 Horizontal LOCK screw
- 5 [D/N - ON/OFF] Easy day/night switch
- 6 [FOCUS ADJ. - ON/OFF] Focus adjustment switch
- 7 [AGC - ON/OFF] Auto gain control switch
- 8 [BLC - ON/OFF] Backlight compensation switch
- 9 [AUTO/MANU] Auto/Manual selection switch for white balance
- 10 [INT/LL] Synchronisation system selection switch
- 11 [WHT.BAL/PHASE] Adjustment selection switch
- 12 [R/B, +/-] Adjustment button
- 13 [RESET] Reset button
- 14 [SPOT CORRECTION] White spot correction button

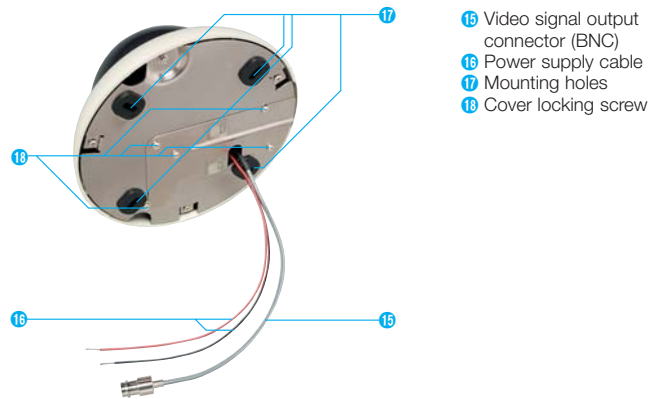

- 15 Video signal output connector (BNC)
- 16 Power supply cable
- 17 Mounting holes
- 18 Cover locking screw

Specifications

CAMERA	
Signal system	PAL
Image device	1/4" IT CCD
Number of effective pixels	440,000 pixels, 752 (H) x 582 (V)
Sync system	Internal, Line lock
Video S/N	50 dB (AGC off, typical)
Horizontal resolution	540 TV lines (typical)
Minimum illumination (Typical)	Colour mode 2.4 lx (F1.2, AGC on, 25% video, wide end) 0.9 lx (F1.2, AGC on, 25% video, wide end) with clear dome cover 4.8 lx (F1.2, AGC on, 50% video, wide end)
	B&W mode 1.6 lx (F1.2, AGC on, 25% video, wide end) 0.7 lx (F1.2, AGC on, 25% video, wide end) with clear dome cover 3.2 lx (F1.2, AGC on, 50% video, wide end)
White balance	ATW/Manual
ATW	Colour temperature range 2,300K to 10,000K
Backlight compensation	ON/OFF
LENS	
Focal length	2.6 mm to 6 mm (variable)
Max. aperture ratio	F1.2 to F1.8
Angle of vision	f = 2.6 mm 82° (H) x 59° (V) f = 6 mm 35° (H) x 26° (V)
Angle adjustment range	Horizontal: 120° Vertical: 130° Tilt: 30°
GENERAL	
Power supply	AC 24 V (50 Hz/60 Hz), DC 12 V
Power consumption	300 mA
Weight	570 g
Operating temperature	-10°C to 50°C (recommended: 0°C to 40°C)
Dimensions	ø156 mm x 89 mm (H)
Accessory	Instructions x 2, Template x 1

Dimensions

Unit: mm

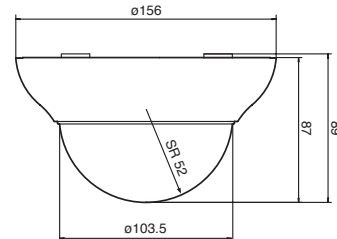

Design and specifications subject to change without notice.

JVC®

DISTRIBUTED BY



Professional Systems company of Victor Company of Japan, Ltd. has received ISO14001 and ISO9001 Certifications under the global standard for environmental management.

Printed in Japan

KCN-1833B CETKC205EY0504

"JVC" is the trademark or registered trademark of Victor Company of Japan, Limited.